



ANGEL REAL ESTATE
GROUP

“SELL THE WORLD TO THE WORLD
SERVICE THE WORLD TO THE WORLD”

CONTENTS

3	About us
4	Key Competence
5	Core Business
7	Service Provided
9	Our Global Reach
12	Current Project
22	Industrial Land
26	Project Management



ABOUT US



Starting operations in 2014, Angel Real Estate was formed by a skillful team with backgrounds in different sectors related to the properties market in Thailand and Turkiye. The company used all the different insights to create bespoke investment solutions to the clients.

Throughout the years it has consolidated its position as one of the most reliable entities for those who care to make their investments internationally.

The year 2023 marks a new era for Angel Real Estate to expand and diversify more services to international market such as Angel Club, Used Properties, Property Leasing, Hospitality Services, Industrial Land Factories, Land and Thailand Privilege Card

KEY COMPETENCE

- Worldwide Network & Partnership
- In depth knowledge and professional in international market
- Strong and extensive network of business partnership
- Full range of One Stop Services
- Sold more than 12,500 condominium units since 2014 with 20,000 customer's base



CORE BUSINESS



ANGEL REAL ESTATE

- New Project Sales & Marketing
- Asset Management Properties Sales & Marketing
- Property Management
- Project Consultancy
- Property for sales and rent
- After Sale Services
- Thailand Privilege Card
- Industrial Land & Factories, Cities & Agriculture Land

MANAGEMENT TEAM



Mr. Simon Lee
Chairman



Mr. Han Luo
Chief Executive Officer



Mr. Xuetao Feng
Chief Operating Officer



Mr. Chana Nuntachantoon
Senior Vice President

REGIONAL OFFICES

- Thailand (Regional Offices)
(Bangkok, Chiangmai, Phuket)
- Hong Kong Office
- Malaysia (Lauban Office)
- China
(Beijing, Chengdu, Shanghai)
- Liaison Office - Japan/ Turkiye
Myanmar/Brunei

Recovering from Covid Pandemic, in 2023 Angel Real Estate facing all up and down in the past 10 years, has strongly established and provided better selection of

- 1) Good location, Quality Condominium, Housing Projects and Building in Bangkok, Chiangmai, Phuket and Istanbul (Turkiye)
- 2) Asset management good quality used housing and condominium
- 3) Industrial Land and Factories
- 4) Land in Bangkok, Phuket, Chiangmai and Pattaya
- 5) Agriculture Land
- 6) Hotels
- 7) Project management services thru our subsidiary company CBMT
- 8) Thailand Privilege Card and other Visa services
- 9) Rental: short and long term, Furniture package, Maid services, Transfer ownership services and Transportation services

- Own brand management strategy
- Diversified business model
- Global customer service foundation
- International real estate marketing experience
- Multiple targets audiences and marketing strategies
- Wide and solid business partnership

OUR GLOBAL REACH

ANGEL REAL ESTATE

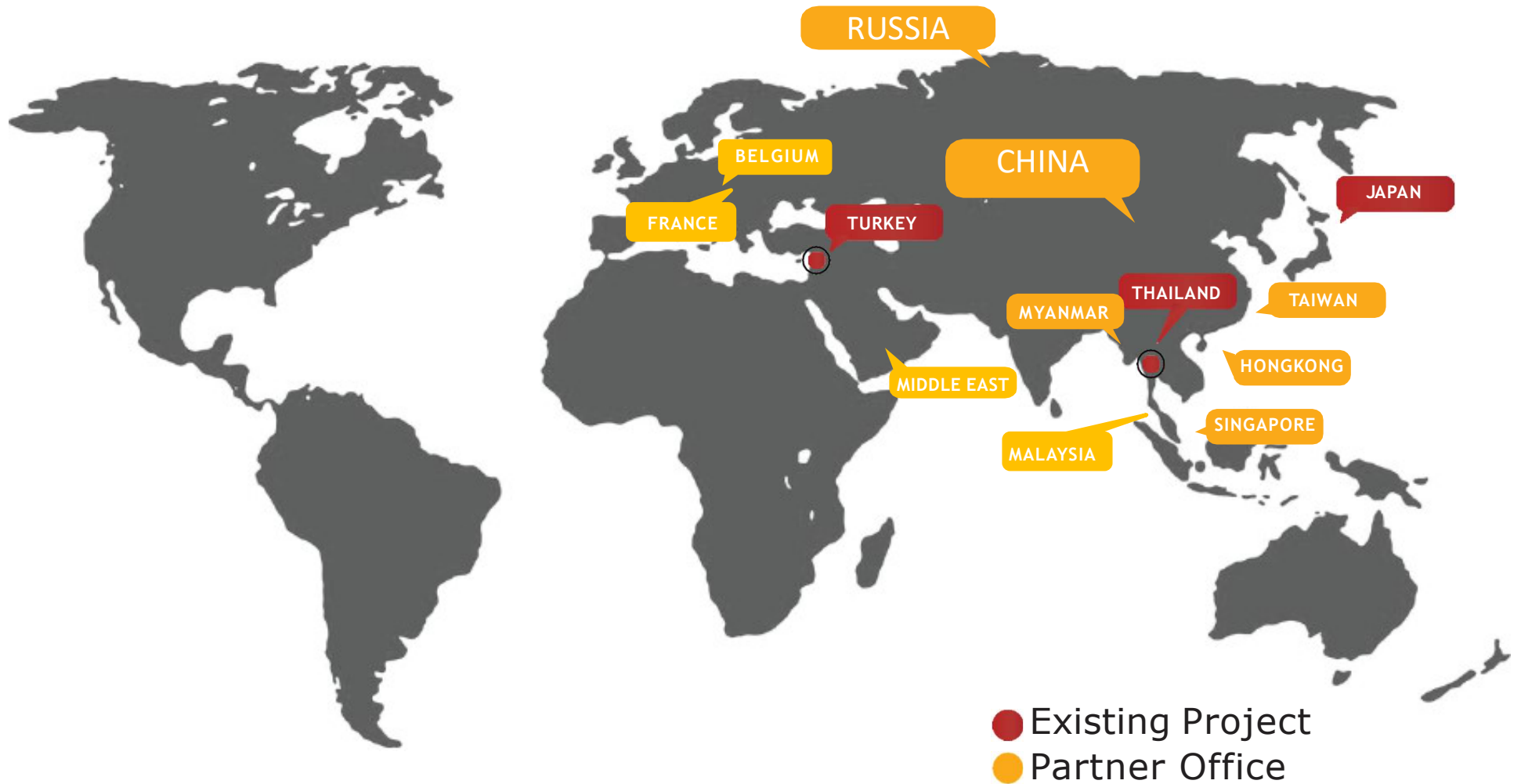

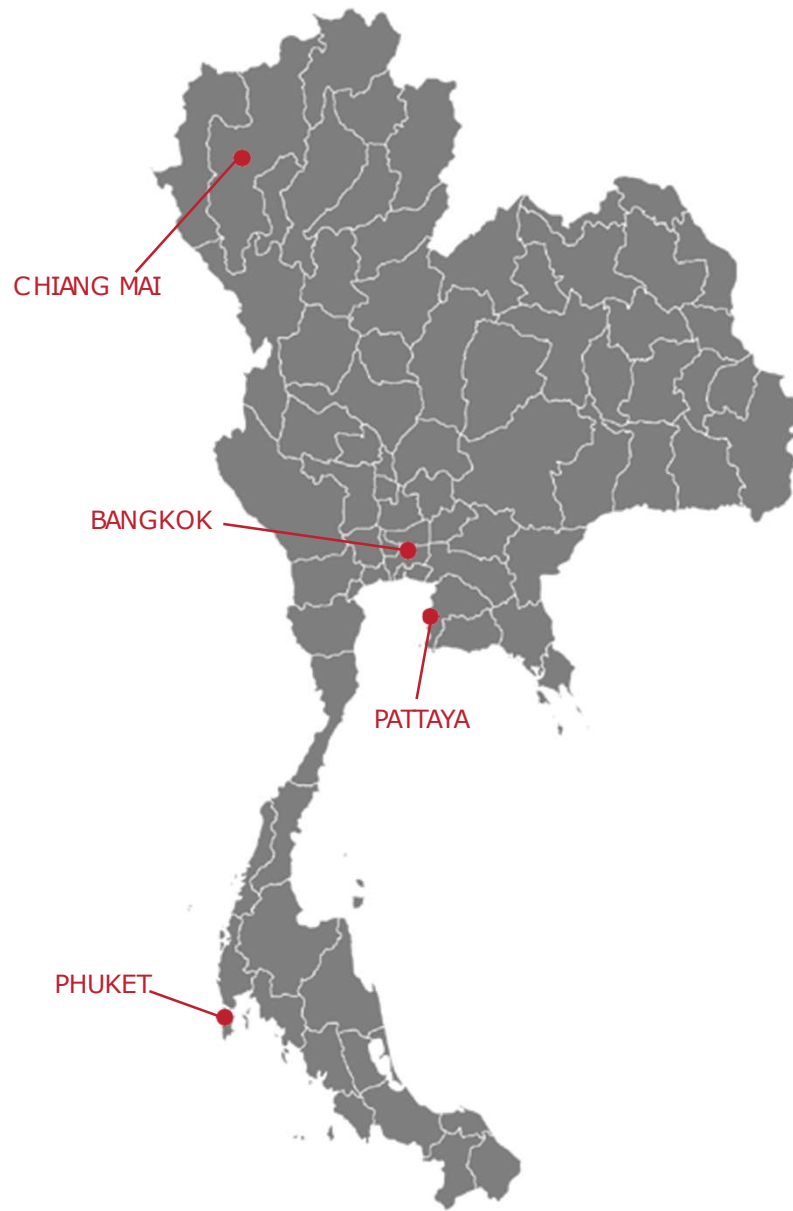

THAILAND PROJECTS

CONDOMINIUM & HOUSING

ANGEL REAL ESTATE



SIAMESE
RAMA 9



THE ROOM
SUKHUMVIT 38



SUPALAI
ICON-SATHORN



SUPALAI
OREINTAL
SUKHUMVIT39



FYNN
SUKUMVIT 10



ARISE
CHAROEN MUEANG



HABITAT
SUPER HIGHT WAY



CHEWATHAI
THONGLOR



COMO
PRIMO



THAILAND PROJECTS

BANGKOK CONDOMINIUM & HOUSING

ANGEL REAL ESTATE



Land & House

The Room Sukhumvit 38
The Bangkok Thonglor
The Room Phayathai
The Key Srinakarin

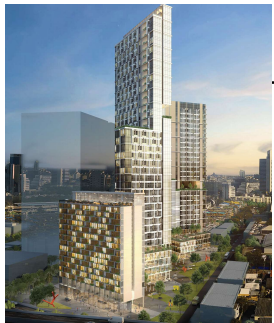

Siamese Asset

Siamese Rama 9



Housing

Artale Rama 9
Airi KM. 5
Como Primo
Como Botanica
Cinq Royal Krungthep Kreetha

Supalai

Supalai Icon Sathorn
Supalai Oriental Sukhumvit 39
Supalai Prime Rama 9
Supalai Veranda Sukhumvit 117
Supalai City Resort Sukhumvit 107
Supalai Parc



Chan Issara

Baan Bangna
The Issara Sathorn



Others

Life Rama 4-Asoke
Scope Thonglor & Langsuan
Chewathai Thonglor
COBE Ratchada
Skyrise Avenue Sukhumvit 64
Serio Sukhumvit 50
8 Residence
Fynn Asoke



And many more..

THAILAND PROJECTS

HOUSING PROJECT

ANGEL REAL ESTATE



Supalai Prime Villa, New
Krungthep Kreetha Road -
Motorway



Supalai Elegance
Phaholyothin 50



COMO BOTANICA II BANGNA



COMO BIANCA II BANGNA



COMO PRIMO Bangna



ARTALE ASOKE - RAMA 9



AIRI SUKHUMVIT-BANGNA
KM 5



BAAN ISSARA BANGNA

THAILAND PROJECTS

CHAINGMAI

ANGEL REAL ESTATE

ARISE CHAROEN-MUANG



ARISE MAHIDOL



ASTRA
SKY-RIVER



ORNSIRIN HABITAT
ORNSIRIN BELIVE
ORNSIRIN VILLE



ASTRA 3
coming soon



THE NEXT JEDYOD
PH 1 & 2



ARISE HILL

THAILAND
PROJECTS

PHUKET

ANGEL REAL ESTATE



ARISE VIBE PHUKET



SOLD
40 UNITS

AVAILABLE
3 UNITS

JAPAN PROJECT

FREE HOLD LANDED HOUSE
FREE HOLD CONDOMINIUM

ANGEL REAL ESTATE

BENTENCHO

2-3-4 Ichioka, Minato, Osaka City



HASHIMOTO

2-3-12 nakamoto higashinari, Osaka City



SENBONKITA

2-17-4 Hayashiji, Ikuno-ku, Osaka City





SOLD
23 UNITS

AVAILABLE
15 PROJECTS

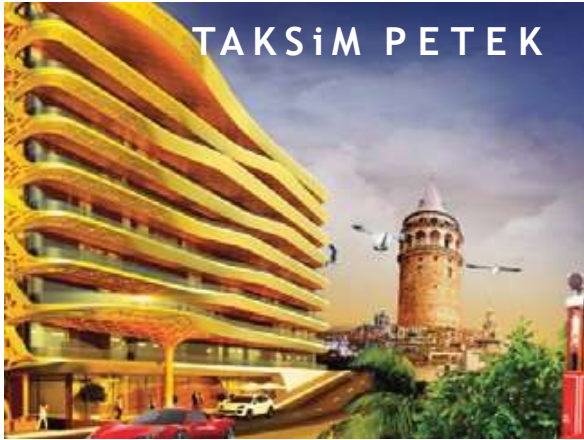

HOTEL

ANGEL REAL ESTATE

Thailand is the world's top tourism destination. Many hotels and resorts have welcomed a lot of visitors from every part of the world. Along with the growing of country's tourism, Thailand's hotel industry have been developing rapidly in the last decades. International hotel chains and local developers are scaling business up in Bangkok, Chiang Mai, Pattaya and Phuket.

Having a strong business connection with many local and foreign investors, Angel Real Estate can facilitate our partners as an investment matchmaker to introduce 3 to 5 stars profitable hotels. Our experienced talent will support clients' requirements with a professional expertise.



HOTEL

ANGEL REAL ESTATE





INDUSTRIAL Land & Factories

INDUSTRIAL LAND

ANGEL REAL ESTATE

Angel Real Estate provides a full-service for industrial and Factories acquisition, mini-factory warehouse and logistic, Also we do provide after-sell service such as setting-up company and accommodation and etc

As the industrial development trend has shift rapidly, Thailand's government had announced the "Eastern Eco- nomic Corridor (EEC)" campaign under scheme of Thailand 4.0 aiming to revitalize and to enhance the well-known Eastern Seaboard Development Program supporting Thailand as a powerhouse for industrial pro- duction for over 30 years. The project situated in EEC area shall be supported and subsidized in total pipeline of production with assorted benefits of logistic, transportation.



AMATA
POSSIBILITIES HAPPEN



WHA
GROUP

PINTHONG
INDUSTRIAL ESTATE



INDUSTRIAL ESTATE

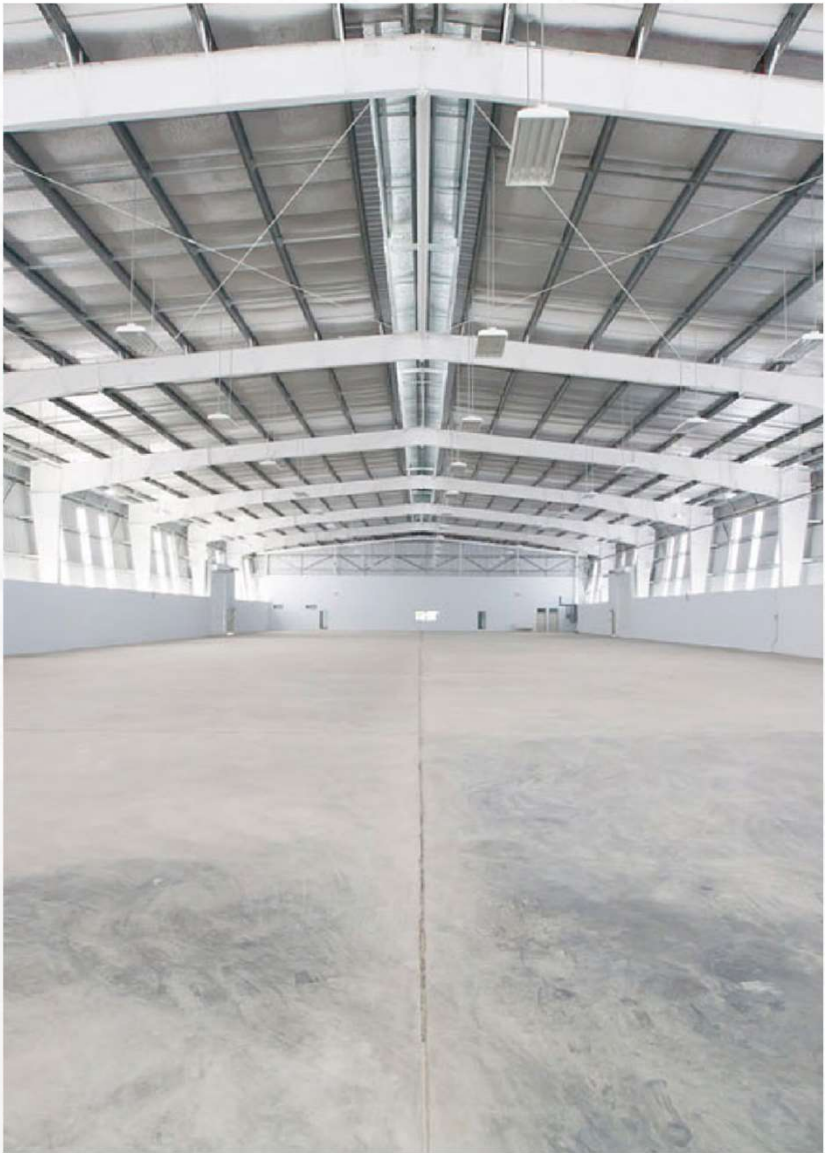

MINI FACTORY

LOGISTICS

WAREHOUSE

The industry will have a chance to enjoy the BOI incentive providing tax incentive and non-tax incentive.



1. Tax Incentives

- Exemption of corporate income tax for up to 13 years
- 50% reduction in corporate income tax for 5 years
- Exemption of import duties on machinery.
- Exemption of import duties on raw or essential materials used in production for export.
- Exemption of import duties on raw or essential materials used in research and development purposes.



2. Non-Tax Incentives

- 100% foreign ownership.
- Permit to own land.
- Permit to bring in skilled workers and experts to work into the Kingdom.

PROJECT MANAGEMENT

HOSPITALITY MANAGEMENT FACILITY
MANAGEMENT
CBMT

FACILITY MANAGEMENT



AFTER SALES SERVICE
ANGEL CLUB

WHAT IS ANGEL CLUB ?

Angel Club is setup as our business unit dedicated to serving the clientele who invested in Angel Real Estate recommended properties or Consultancy projects in Thailand. We also provide the excellent concierge services for the needs of our clients.



SERVICE PROVIDED

IN-HOUSE SERVICES

- Furniture Packages
- Smart Home Packages
- Rental Service Packages
- Plumbing - Maintenance
- Electrical - Maintenance
- Maid Services

SUPPLEMENTARY SERVICES

- Thailand Privilege Cards
- International Schools – Recommendation
- Legal Services - Recommendation
- Thai Immigration Visa
- Turkiye Migration Service
- Car Rental & Transportation
- Translation Service
- Hospitals – Health Check up



THAILAND
PRIVILEGE
CARD

Thailand Privilege



**“Angel Real Estate
Is An Authorized Agent
On Behalf Of
Thailand Privilege Card
In Order To Offer Membership
As Code SA23/005”**



THAILAND PRIVILEGE CARD



The Gold Card offers you a life of value during your stay in Thailand, providing a diverse range of living choices.

5 Years
VALIDITY

900,000 THB
MEMBERSHIP FEE



The Platinum Card grants you the opportunity to relish any desired living experience in Thailand, offering an expanded array of choices and an extended stay duration.

10 Years
VALIDITY

1,000,000 THB
MEMBERSHIP FEE



The Diamond Card, experience a redefined luxury living in Thailand, offering a maximum 15-year stay with exclusive access and privileges tailored to your desired living experience.

15 Years
VALIDITY

2,500,000 THB
MEMBERSHIP FEE

VISA

- Long-term VISA from 5 up to 20 years++

AIRPORT VIP SERVICES

- VIP Greeting and Assistance
- Fast track immigration
- Airport transfer
- Airport lounge access

LIFESTYLE PRIVILEGES

STAY

- Complimentary membership from leading hotel chains
- Free complimentary night
- Special privileges from hotels and real estate partners nationwide

TRAVEL

- Free domestic ticket
- Special deals from airlines, river cruise, limousine and car rental

LEISURE

- Lifestyle privileges and discounts from lifestyle partners
- Exclusive offers, lounge access, personal shopper at leading shopping centers
- World class entertainment and concert tickets
- VIP movie tickets at leading cinemas
- Co-working space

HEALTH & WELL-BEING

- Complimentary spa, health and wellness packages
- Complimentary health check-up
- Access to fitness clubs

WEALTH

- Wealth and Investment advisor
- Networking and Seminar



Thank You

 ANGEL REAL ESTATE