



# ANGEL REAL ESTATE GROUP

“SELL THE WORLD TO THE WORLD  
SERVICE THE WORLD TO THE WORLD”



# CONTENTS

3	About us
4	Key Competence
5	Core Business
7	Service Provided
9	Our Global Reach
12	Current Project
22	Industrial Land
26	Project Management



# ABOUT US



Starting operations in 2014, Angel Real Estate was formed by a skillful team with backgrounds in different sectors related to the properties market in Thailand and Turkiye. The company used all the different insights to create bespoke investment solutions to the clients.

Throughout the years it has consolidated its position as one of the most reliable entities for those who care to make their investments internationally.

The year 2023 marks a new era for Angel Real Estate to expand and diversify more services to international market such as Angel Club, Used Properties, Property Leasing, Hospitality Services, Industrial Land Factories, Land and Thailand Privilege Card



## KEY COMPETENCE

- Worldwide Network & Partnership
- In depth knowledge and professional in international market
- Strong and extensive network of business partnership
- Full range of One Stop Services
- Sold more than 13,500 condominium units since 2014 with 25,000 customer's base





# CORE BUSINESS

- New Project Sales & Marketing
- Asset Management Properties Sales & Marketing
- Property Management
- Project Consultancy
- Property for sales and rent
- After Sale Services
- Thailand Privilege Card
- Industrial Land & Factories, Cities & Agriculture Land



# MANAGEMENT TEAM



Mr. Simon Lee  
Chairman



Mr. Han Luo  
Chief Executive Officer



Mr. Xuetao Feng  
Chief Operating Officer



Mr. Chana Nuntachantoon  
Senior Vice President



## REGIONAL OFFICES

- Thailand (Regional Offices)  
(Bangkok, Chiangmai, Phuket, Samui and Pattaya)
- Hong Kong Office
- Malaysia (Lauban Office)
- China  
(Beijing, Chengdu, Shanghai)
- Liaison Office - Japan/ Turkiye  
Myanmar/Brunei



Recovering from Covid Pandemic, in 2025 Angel Real Estate facing all up and down in the past 12 years, has strongly established and provided better selection of

- 1) Good location, Quality Condominium, Housing Projects and Building in Bangkok, Chiangmai, Phuket, Samui, Pattaya and Istanbul (Turkiye)
- 2) Asset management good quality used housing and condominium
- 3) Industrial Land and Factories in EEC zone
- 4) Land in Bangkok, Phuket, Samui, Chiangmai and Pattaya
- 5) Agriculture Land
- 6) Hotels
- 7) Project management services thru our subsidiary company CBMT
- 8) Thailand Privilege Card and other Visa services
- 9) Rental: short and long term, Furniture package, Maid services, Transfer ownership services and Transportation services

# Core Competitiveness

- Own brand management strategy
- Diversified business model
- Global customer & Investors service foundation
- International real estate marketing experience
- Multiple targets audiences and marketing strategies
- Wide and solid business partnership



# OUR GLOBAL REACH

ANGEL REAL ESTATE

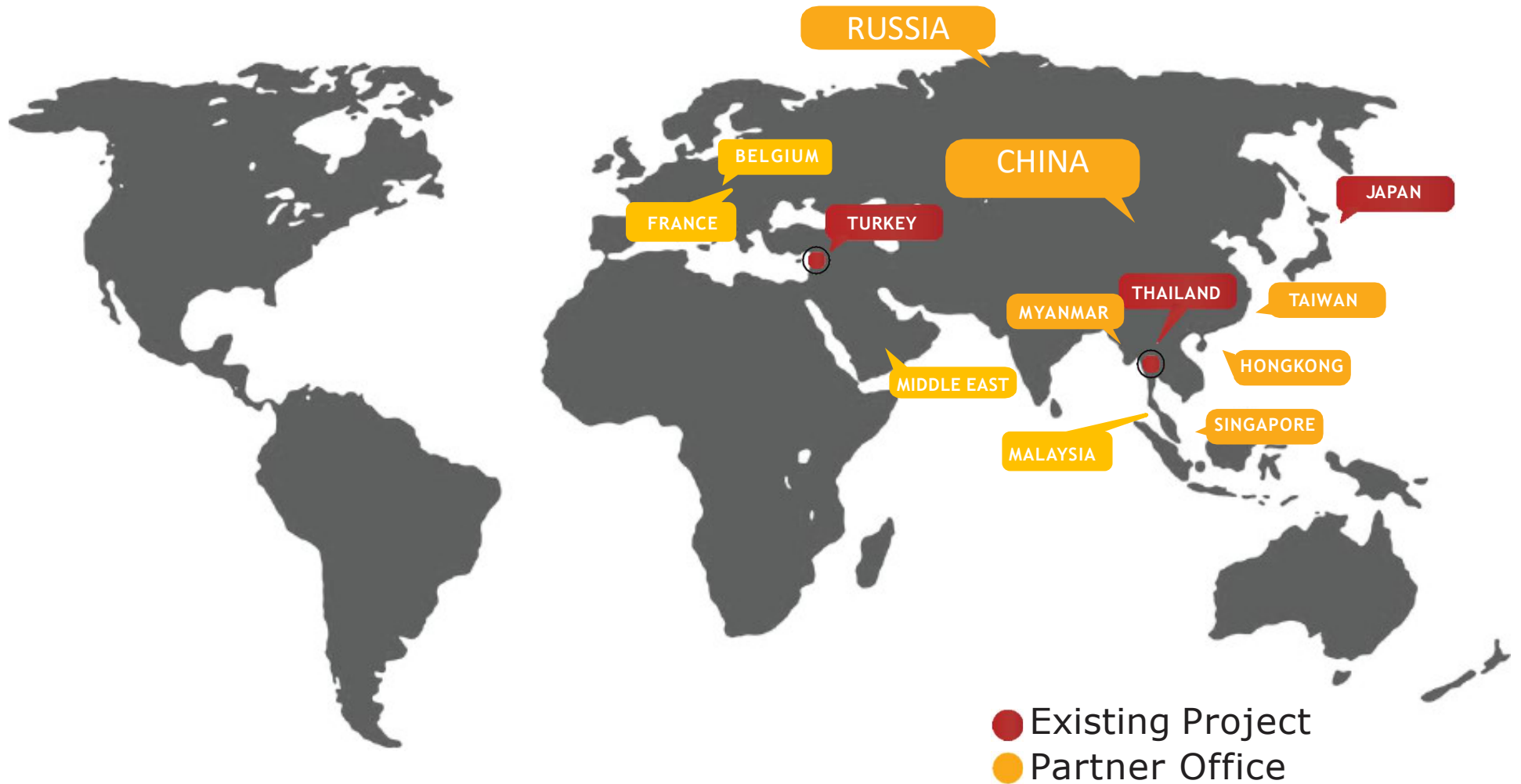

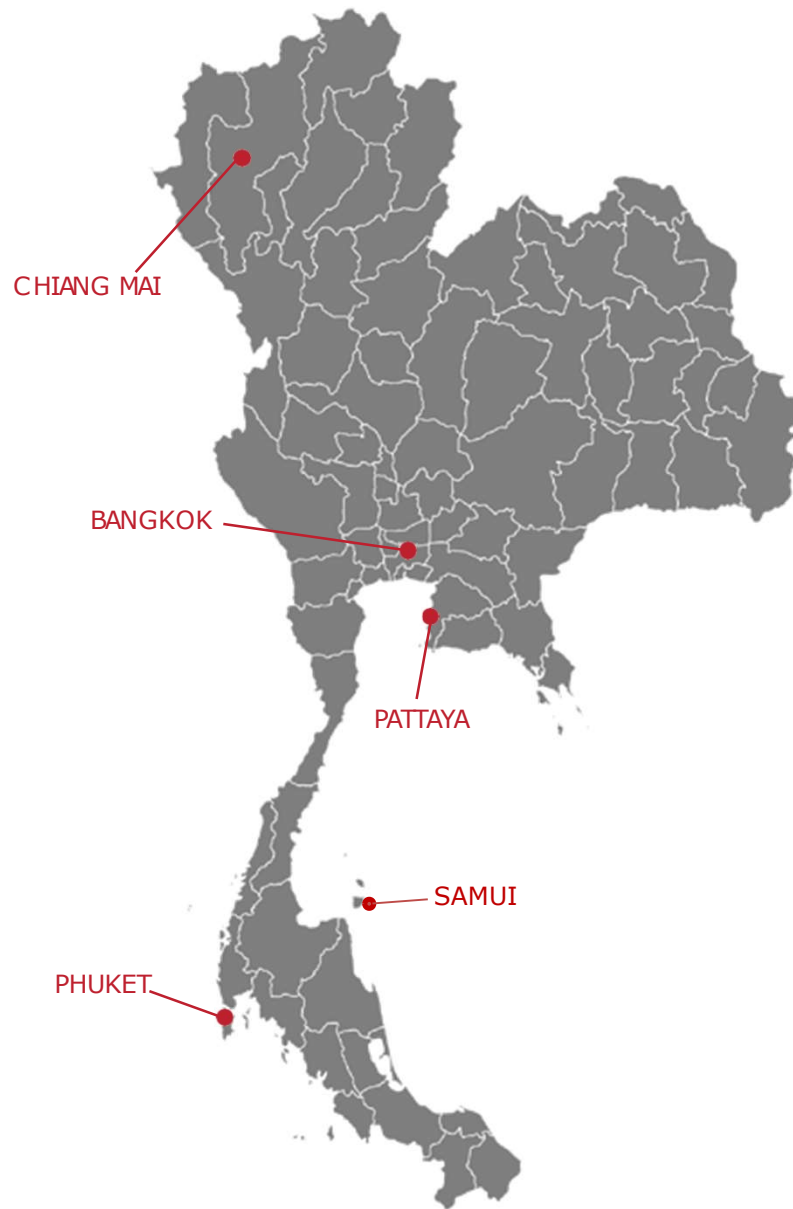

CHIANG MAI

BANGKOK

PATTAYA

SAMUI

PHUKET



# THAILAND PROJECTS

# CONDOMINIUM & HOUSING

ANGEL REAL ESTATE



SIAMESE  
RAMA 9



THE ROOM  
SUKHUMVIT 38



SUPALAI  
ICON-SATHORN



SUPALAI  
OREINTAL  
SUKHUMVIT39



FYNN  
SUKUMVIT 10



ARISE  
CHAROEN MUEANG



HABITAT  
SUPER HIGHT WAY



CHEWATHAI  
THONGLOR



COMO  
PRIMO



# THAILAND PROJECTS

# BANGKOK CONDOMINIUM & HOUSING

ANGEL REAL ESTATE



## Land & House

The Room Sukhumvit 38  
The Bangkok Thonglor  
The Room Phayathai

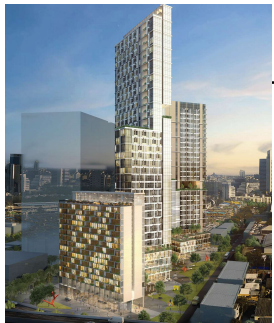

## Siamese Asset

Siamese Rama 9



## Housing

Artale Rama 9  
Airi KM. 5  
Como Primo  
Como Botanica II  
Cinq Royal Krungthep Kreetha

## Supalai

Supalai Icon Sathorn  
Supalai Oriental Sukhumvit 39  
Supalai Prime Rama 9  
Supalai Veranda Sukhumvit 117  
Supalai City Resort Sukhumvit 107  
Supalai Parc



## Chan Issara

Baan Bangna  
The Issara Sathorn



## Others

Scope Thonglor & Langsuan  
U CHAROEN Residence  
Beat Sukhumvit 93  
Chewathai Thonglor  
Fynn Asoke  
Origin Ladprao  
Skyrise Avenue Sukhumvit 64  
8 Residence



*And many more..*



# THAILAND PROJECTS

## HOUSING PROJECT

ANGEL REAL ESTATE



Supalai Prime Villa, New  
Krungthep Kreetha Road -  
Motorway



Supalai Elegance  
Phaholyothin 50



COMO BOTANICA II BANGNA



COMO BIANCA II BANGNA



COMO PRIMO Bangna



ARTALE ASOKE - RAMA 9



AIRI SUKHUMVIT-BANGNA  
KM 5



BAAN ISSARA BANGNA

# THAILAND PROJECTS

## CHAINGMAI

ANGEL REAL ESTATE

ARISE CHAROEN-MUANG



ARISE MAHIDOL



ASTRA  
SKY-RIVER



ORNSIRIN HABITAT  
ORNSIRIN BELIVE  
ORNSIRIN VILLE



ASTRA 3  
coming soon



THE NEXT JEDYOD  
PH 1 & 2



ARISE HILL

THAILAND  
PROJECTS

PHUKET

ANGEL REAL ESTATE



ARISE VIBE PHUKET





SOLD  
**40** UNITS

AVAILABLE  
**3** UNITS

# JAPAN PROJECT

FREE HOLD LANDED HOUSE  
FREE HOLD CONDOMINIUM

ANGEL REAL ESTATE

## BENTENCHO

2-3-4 Ichioka, Minato, Osaka City



## HASHIMOTO

2-3-12 nakamoto higashinari, Osaka City



## SENBONKITA

2-17-4 Hayashiji, Ikuno-ku, Osaka City





SOLD  
**23** UNITS

AVAILABLE  
**15** PROJECTS



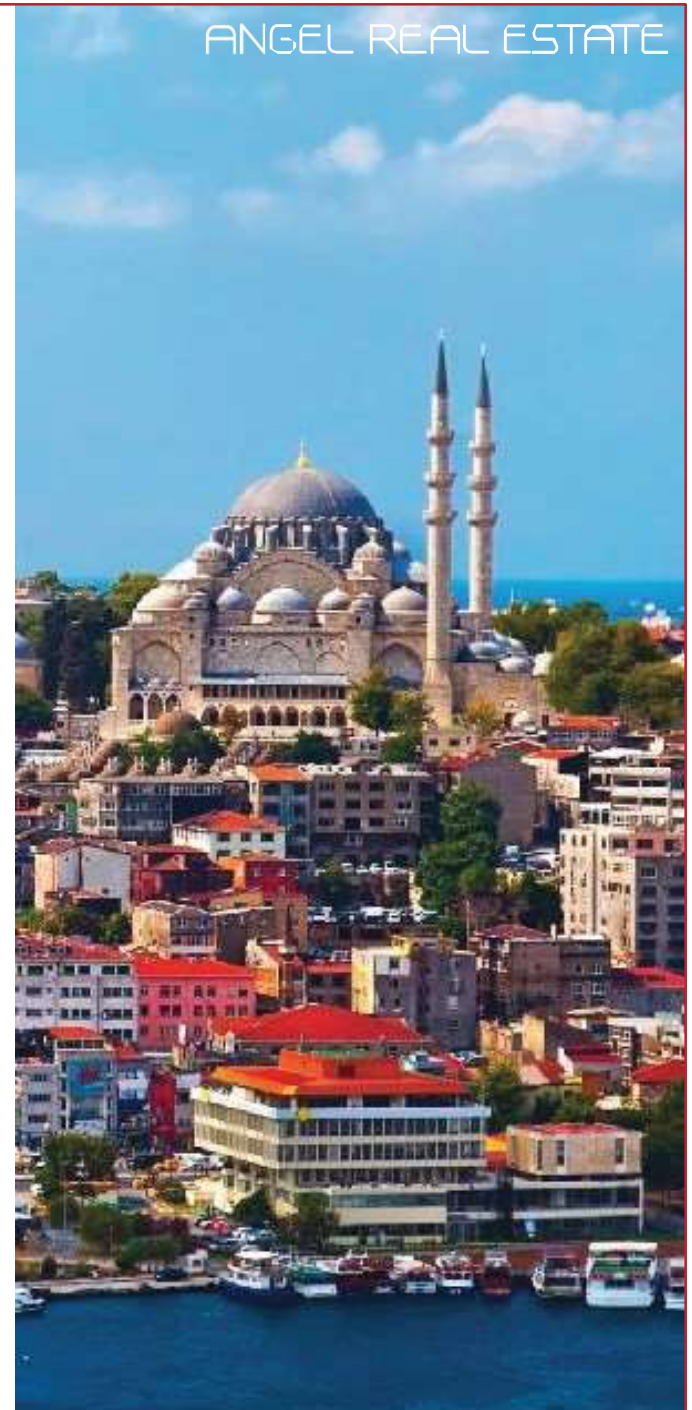
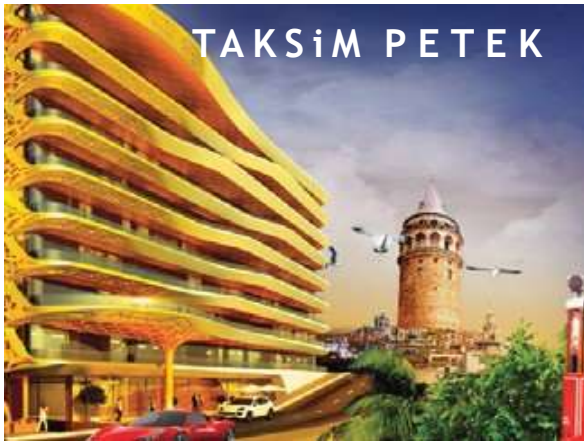

# HOTEL

ANGEL REAL ESTATE

**Thailand** is the world's top tourism destination. Many hotels and resorts have welcomed a lot of visitors from every part of the world. Along with the growing of country's tourism, Thailand's hotel industry have been developing rapidly in the last decades. International hotel chains and local developers are scaling business up in Bangkok, Chiang Mai, Pattaya and Phuket.

Having a strong business connection with many local and foreign investors, Angel Real Estate can facilitate our partners as an investment matchmaker to introduce 3 to 5 stars profitable hotels. Our experienced talent will support clients' requirements with a professional expertise.





# HOTEL

ANGEL REAL ESTATE







**INDUSTRIAL** Land & Factories

# INDUSTRIAL LAND

ANGEL REAL ESTATE

**Angel Real Estate** provides a full-service for industrial and Factories acquisition, mini-factory warehouse and logistic, Also we do provide after-sell service such as setting-up company and accommodation and etc

As the industrial development trend has shift rapidly, Thailand's government had announced the "Eastern Eco- nomic Corridor (EEC)" campaign under scheme of Thailand 4.0 aiming to revitalize and to enhance the well-known Eastern Seaboard Development Program supporting Thailand as a powerhouse for industrial pro- duction for over 30 years. The project situated in EEC area shall be supported and subsidized in total pipeline of production with assorted benefits of logistic, transportation.





INDUSTRIAL ESTATE



MINI FACTORY

LOGISTICS

WAREHOUSE



The industry will have a chance to enjoy the BOI incentive providing tax incentive and non-tax incentive.



## 1. Tax Incentives

- Exemption of corporate income tax for up to 13 years
- 50% reduction in corporate income tax for 5 years
- Exemption of import duties on machinery.
- Exemption of import duties on raw or essential materials used in production for export.
- Exemption of import duties on raw or essential materials used in research and development purposes.



## 2. Non-Tax Incentives

- 100% foreign ownership.
- Permit to own land.
- Permit to bring in skilled workers and experts to work into the Kingdom.

# PROJECT MANAGEMENT

HOSPITALITY MANAGEMENT FACILITY  
MANAGEMENT  
CBMT



# FACILITY MANAGEMENT



**AFTER SALES SERVICE**  
ANGEL CLUB



# WHAT IS ANGEL CLUB ?

Angel Club is setup as our business unit dedicated to serving the clientele who invested in Angel Real Estate recommended properties or Consultancy projects in Thailand. We also provide the excellent concierge services for the needs of our clients.



# SERVICE PROVIDED

## IN-HOUSE SERVICES

- Furniture Packages
- Smart Home Packages
- Rental Service Packages
- Plumbing - Maintenance
- Electrical - Maintenance
- Maid Services

## SUPPLEMENTARY SERVICES

- Thailand Privilege Cards
- International Schools – Recommendation
- Legal Services - Recommendation
- Thai Immigration Visa
- Turkiye Migration Service
- Car Rental & Transportation
- Translation Service
- Hospitals – Health Check up





# THAILAND PRIVILEGE CARD

Thailand Privilege



**“Angel Real Estate  
Is An Authorized Agent  
On Behalf Of  
Thailand Privilege Card  
In Order To Offer  
Membership  
As Code SA23/005”**



# THAILAND PRIVILEGE CARD



## VISA

- Long-term VISA from 5 up to 20 years++

## AIRPORT VIP SERVICES

- VIP Greeting and Assistance
- Fast track immigration
- Airport transfer
- Airport lounge access

## LIFESTYLE PRIVILEGES

### STAY

- Complimentary membership from leading hotel chains
- Free complimentary night
- Special privileges from hotels and real estate partners nationwide

### TRAVEL

- Free domestic ticket
- Special deals from airlines, river cruise, limousine and car rental

### LEISURE

- Lifestyle privileges and discounts from lifestyle partners
- Exclusive offers, lounge access, personal shopper at leading shopping centers
- World class entertainment and concert tickets
- VIP movie tickets at leading cinemas
- Co-working space

### HEALTH & WELL-BEING

- Complimentary spa, health and wellness packages
- Complimentary health check-up
- Access to fitness clubs

### WEALTH

- Wealth and Investment advisor
- Networking and Seminar



The Gold Card offers you a life of value during your stay in Thailand, providing a diverse range of living choices.

**5 Years**  
VALIDITY

**900,000 THB**  
MEMBERSHIP FEE



The Platinum Card grants you the opportunity to relish any desired living experience in Thailand, offering an expanded array of choices and an extended stay duration.

**10 Years**  
VALIDITY

**1,000,000 THB**  
MEMBERSHIP FEE



The Diamond Card, experience a redefined luxury living in Thailand, offering a maximum 15-year stay with exclusive access and privileges tailored to your desired living experience.

**15 Years**  
VALIDITY

**2,500,000 THB**  
MEMBERSHIP FEE



The Bronze Membership Package has been designed to focus on these essential services while maintaining the standards of Thailand Privilege Card Membership.

**5 Years**  
VALIDITY

**650,000 THB**  
MEMBERSHIP FEE



Thank You

 ANGEL REAL ESTATE